

Operation Instructions

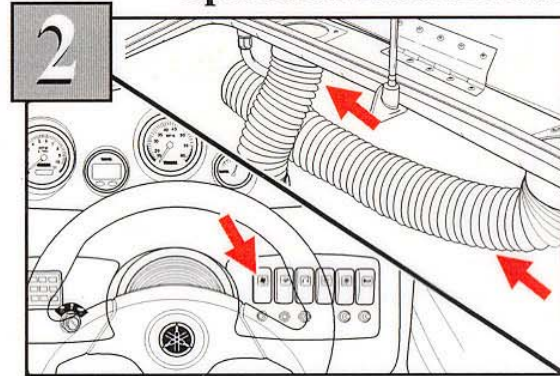

1 Everyone on board must wear a USCG-approved personal flotation device (PFD).



2 Operate blower for at least 4 minutes and check engine compartment bilge for gasoline vapors before starting engine. Do not start the engine if there is a fuel leak or loose electrical connection.

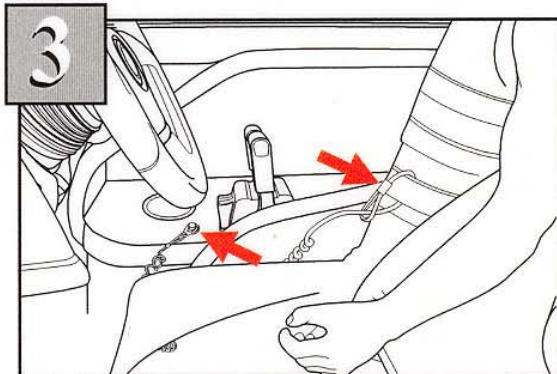

3 Attach engine shut-off cord to your PFD, then insert cord clip on engine shut-off switch. Failure to attach the lanyard could result in a runaway boat if operator is ejected. The engine cannot be started unless the clip is installed.

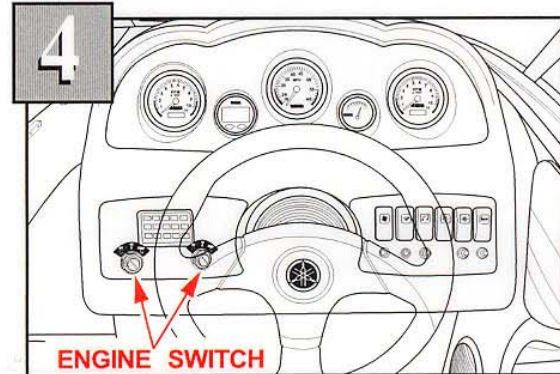

4 To start engine turn key in main switch to "START." Release key when engine starts.

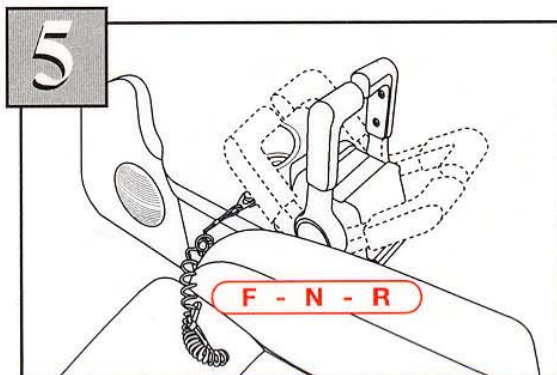

5 Select Forward or Reverse, then accelerate by gradually pushing throttle lever in the desired direction.

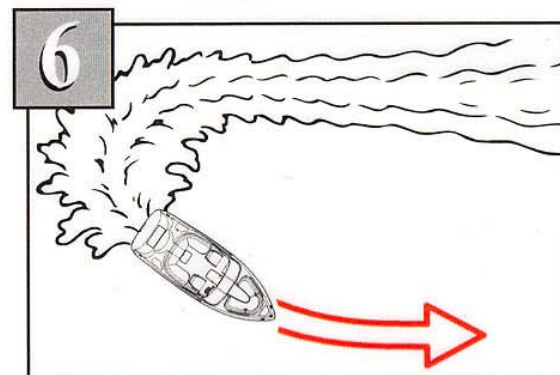

6 Turn the steering wheel in the direction you wish to travel while applying throttle. **YOU NEED THROTTLE TO STEER.**

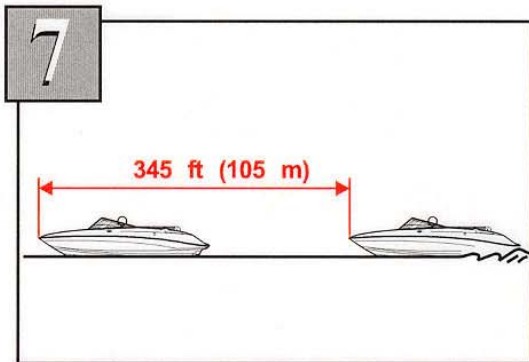

To stop: return the throttle to idle and coast to a stop. There are no brakes on a sport boat. Stopping distance from full speed is approximately 345 feet. You have no steering control with the engine stopped. Do not shift into Reverse at planing speeds. Use Reverse only for low speed maneuvering.

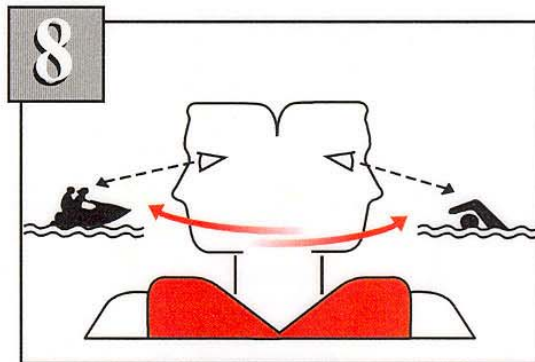

Scan constantly for people, objects, and other watercraft. Be alert for conditions that limit your visibility or block your vision of others. Operate defensively at safe speeds and keep a safe distance from people, objects, and other watercraft. Take early action to avoid collisions.

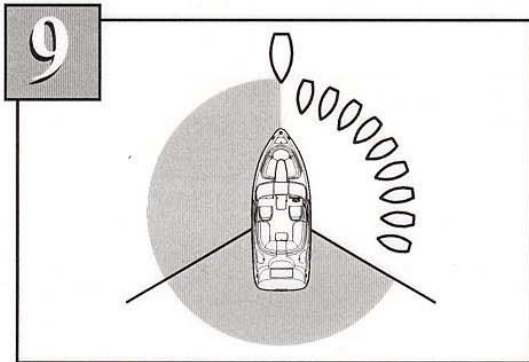

Obey the "Rules of the Road." Yield the right of way to any boat shown in the white area. Do not jump boat wakes, or cross the path of oncoming boats or watercraft.

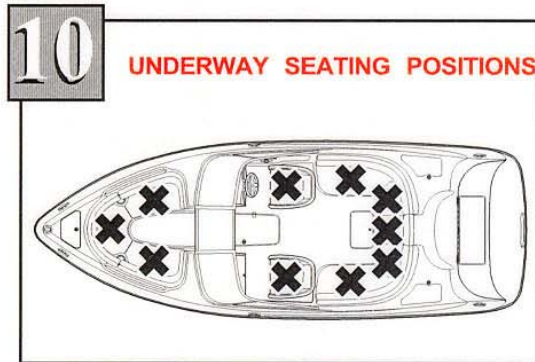

Passengers must sit in one of the seats provided and hold onto the handgrips while putting both feet on the deck.

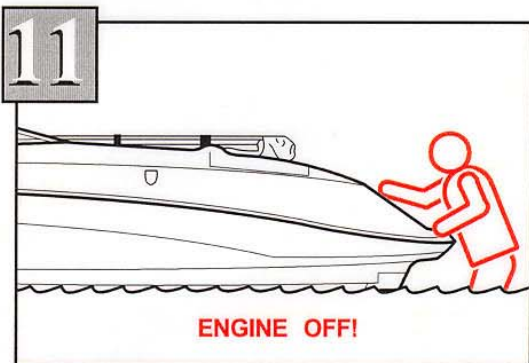

Do not apply throttle when anyone is at rear of boat - turn engines off while boarding from the rear, using the swim platform, or when swimming behind the boat. Water and/ or debris exiting the jet thrust nozzles can cause severe injury, including severe internal injuries if water is forced into body cavities (rectum and vagina).

ALWAYS BE FAMILIAR WITH AND OBSERVE ALL LOCAL BOATING LAWS AND REGULATIONS.
NEVER DRINK AND DRIVE.

FOR COMPLETE OPERATING INSTRUCTIONS, REFER TO THE OWNER'S MANUAL AND BASIC ORIENTATION VIDEO. YAMAHA RECOMMENDS THAT SPORT BOAT OPERATORS BE AT LEAST 16 YEARS OF AGE WITH A VALID MOTOR VEHICLE LICENSE.